

# Installation Guide

---

NOVA-N9

NOVA-N30

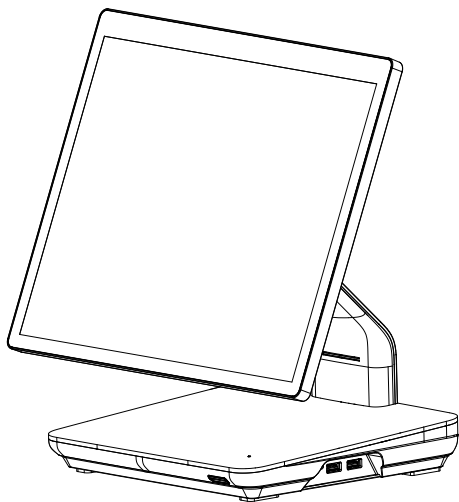

# Safety Precautions

---

## Be sure to read the Safety Precautions before using the POS system.

- Before connecting, make sure the operating voltage is AC100 ~ 240V. Otherwise, you may damage the system.
- Do not install the system in an extremely hot or cold place.
- Avoid exposing the product in direct sunlight or in an enclosed space for a long period of time.
- Be careful not to place the system near other high-frequency electromagnetic devices; there is a strong possibility it will lead to a system malfunction or system error.
- Do not place heavy objects on the system.
- Please do not allow external substances to be contaminated inside the system.
- Do not change the motherboard's battery by yourself. It can damage the system.
- Before disassembling the system, disconnect all power and cables.
- Do not remove or repair the system by yourself. We highly recommend an engineer's assistance or an experienced technician to open the system, especially the LCD and touch panels which could be easily broken.
- An electrical outlet is needed near the device and it should be easily accessible.
- Risk of explosion if battery is replaced by an incorrect type.
- Replace only with the same type of batteries recommended by the manufacturer.
- This device complies with the EMC (Electromagnetic Compatibility) Regulations, for business purposes. Distributors and users are advised of this matter.
- Please exchange the equipment if you mistakenly sold or purchased this product.
- Cleaning and Maintenance is relevantly necessary for POS terminal to be operated well.

## Touch Screen Security Guideline

**Please take special care with the touch panel as it is vulnerable to scratches.**

- Do not use excessive force when using or pressing the touch panel.
- Do not use objects with sharp edges on the touch panel.
- Be careful not to spill any liquid on the screen.
- Turn off the power switch and unplug all cables before cleaning the screen and/or the system.
- Use a soft, clean, dry cloth for cleaning the system, and do not use chemicals or detergents.

# Package Contents

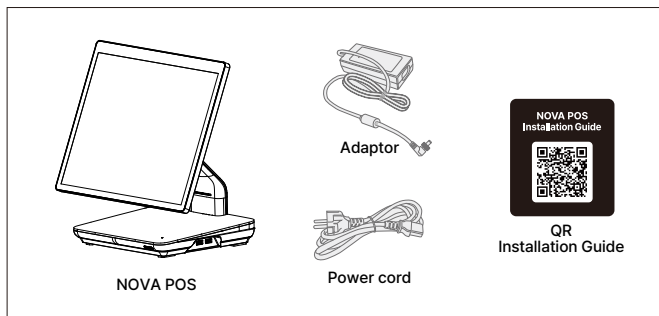

\* Component images are for reference only and may vary by model and option.

## Configuration

### Front/Side/Rear view

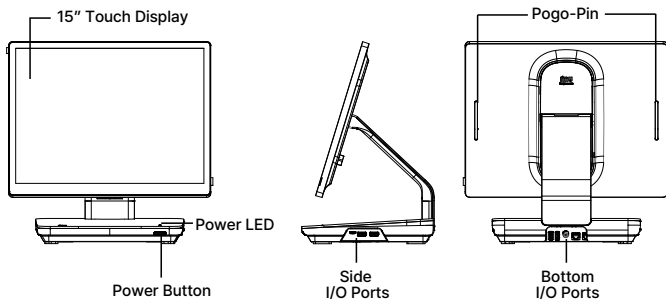

# I/O Ports

## Bottom I/O Ports

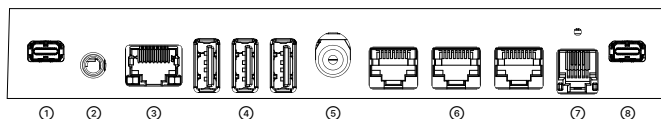

## Side I/O ports

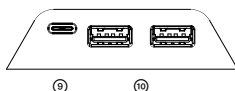

### RJ45 Pin Map Assignments

Signal Name	PJ45
DCD	1
DSR	2
TXD	3
RXD	4
RTS	5
CTS	6
GND	7
DTR	8

1 ~ 8 : RJ45  
1 ~ 10 : RJ50

\* I/O ports can be changed based on models/specifications/options.

From the RJ45 port supply to power connector used by RJ50 plug.  
Should you need further details, please visit our website at [imupos.com](http://imupos.com)

### Description

① DP	⑥ COM 1~3
② Audio	⑦ COM4
③ LAN	⑧ DP++
④ USB2.0 x 3	⑨ USB Type-C
⑤ DC 12V	⑩ USB3.0 x 2

# System Connection

Please install the system referring to video clip thru QR code written in manual.

## Power Cord Connection

- ⚠ Please connect power adaptor DC jack and power cord by turns after all option items are connected.
- ① Please insert power adaptor cable by turning it into DC 12V port
- ② Please connect power cord after assembling it in a reverse way of disassemble.

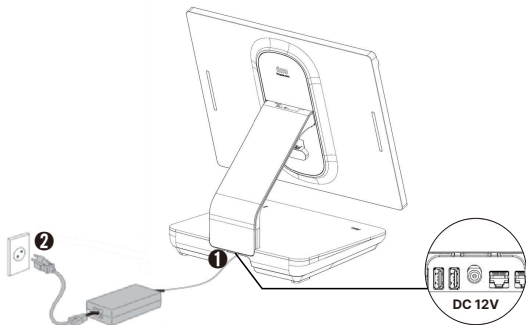

## Power on

- ⚠ Please turn the power on after installing all optional items.

Connect adapter and body rst before connecting power cord to a 220V (110V) outlet.  
**Power supply is located on the lower right side.**

**When power is connected, the LED will light up.**

- ① Power LED : Power Connection (BLUE)
- ② Power Switch



# Installation Options

## 2nd Display

- ⚠ Use a protective support to prevent touchscreen damage during operation.
- ⚠ Please turn it on after connecting all the option items.



- ❶ Remove the stand cover.

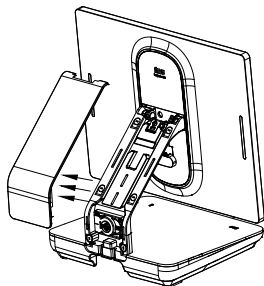

- ❷ Insert in direction 1, then pull fully in direction 2 to align.

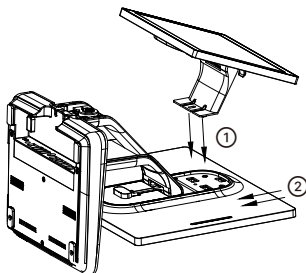

- ❸ Arrange the cable, then fasten the thumb screw. Use a con to tighten it firmly.

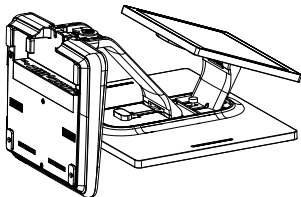

- ❹ Arrange the cable, then attach the stand cover.

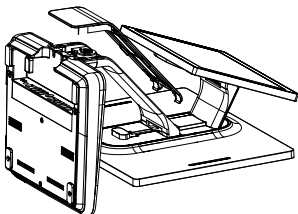

### ① Remove Rubber

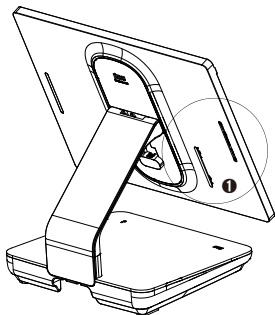

- ❶ Remove the rubber at the position where you want to mount (left or right).  
Use a pen or similar tool to push and pry it from one side to detach.

### ② Attach the Dallas

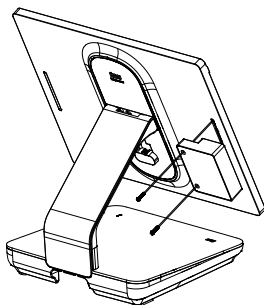

- ❶ Mount the Dallas module using the guide in the designated position.  
❷ Check for a beep sound ("beep") upon proper contact.  
❸ Secure it using the included screw (M3L12).  
→ If lost, use a screw with the same specifications.

# Specifications

NOVA-N9		NOVA-N30
System		
Processor	Intel® Processor N97, up to 3.60 GHz(Fanless)	Intel® Processor i3-N305, up to 3.80 GHz(Fanless)
Chipset / BIOS	Intel® Alder Lake-N SoC / AMI UEFI	
Storage	NVMe M.2 2280 128GB (SSD 256/512GB, optional)	
Memory	4GB SO-DIMM DDR4 3200MHz x 1 (Max 16GB, optional)	
Graphics	Intel® UHD Graphics	
OS	Windows 10 IoT Enterprise(64bit), Windows 11 IoT Enterprise(64bit)	
Display		
Primary Display Type	15" LED Backlight (1024 x 768 Resolution)	
	15.6" LED Backlight (1920 x 1080 Resolution)	
Touch	PCAP 10 Point Multi-touch	
I/O Interfaces		
USB	Rear : 3 x USB 2.0, 1 x USB 2.0(RJ11) / Side : 2 x USB 3.0, 1 x USB Type-C(DP alt mode support)	
Serial	4 (3 x RJ50, 1 x RJ11)	
Audio	1 x Audio-out / 3.5mm	
Extend Displays	2 x MiniDP output(1st Display, 2nd Display)	
LAN	1 x RJ45 (Base-T 10,100,1000m/bps Ethernet)	
Speaker	1 x 3W	
Peripheral Options		
Secondary Display	• LCD Type: 9.7" or 15" or 15.6" - by single cable(Power & Data)	
Customer Display (CDP)	FSTN LCD Type(20 columns x 2 lines)	
Card Reader (MSR / SCR)	Smart Card Reader: ISO/IEC7816 EMV Level 1 / Magnetic Stripe Reader: ISO 7811 ID-1 All tracks	
Dallas Reader	Dallas Reader(i-button): 6 characters / prefix and suffix	
Wireless	802.11 b/g/n/ac, Bluetooth 5.1	
Physical Dimension		
Dimension (W x D x H)	328 x 215 x 338 (mm)	
Box Dimension		
Dimension (W x D x H)	390 x 270 x 390 (mm)	
Environment		
Power Supply	DC 12V/5A (AC 100V~240V, 60W)	DC 12V/7A (AC 100V~240V, 84W)
Temperature	Operating Temp : 0~40°C / Storage Temp : -20~60°C / Humidity : 20% to 90%	
Certifications	CE, FCC, KC	



This user manual is provided for informational purposes and cannot be reproduced or distributed without consent under the Copyright Act. Specifications in the user manual are subject to change without prior notice.